



## IMPORTANT SAFETY INFORMATION



### PLEASE READ THE MANUAL BEFORE USING!



THE MANUAL IS AVAILABLE FROM PRIOR SCIENTIFIC AND SHOULD BE READ AND UNDERSTOOD BEFORE INSTALLATION AND USE. THE MANUAL IS AVAILABLE FROM [WWW.PRIOR.COM](http://WWW.PRIOR.COM)

- Adhere to all warnings on the product and in the user manual.
- This product MUST NOT be exposed to open flames, extremely hot or cold temperature, water or moisture. DO NOT allow objects to fall, or liquids to spill, on the product.
- The ProScan III is a Class I system and must be earthed.
- Connect the AC power cord only to designated power sources as marked on the product. Make sure the electrical cord is located so that it will not be subject to damage.
- Ensure the connection to the power source and the front panel power switch are easily accessible.
- Do not connect or disconnect anything to or from the ProScan III unless the controller is turned off first.
- **DANGER – Never alter the AC cord or plug.** The power cord set must be an appropriately rated and approved cord set in accordance in the regulations of the country it is used in. If the supplied plug adapter is not the correct fitting for your geographic area or if you are unsure about the relevant regulations, please contact your supplier for advice.
- **Do not attempt to disassemble, tamper or repair this product; it contains NO user serviceable parts and doing so may void the warranty.** Service should be performed ONLY by authorised service centres.
- Clean only the exterior of this product using a damp, lint free cloth.
- **Please contact Prior or an approved representative if you have any questions or comments.**



## PROSCAN III CONNECTIONS

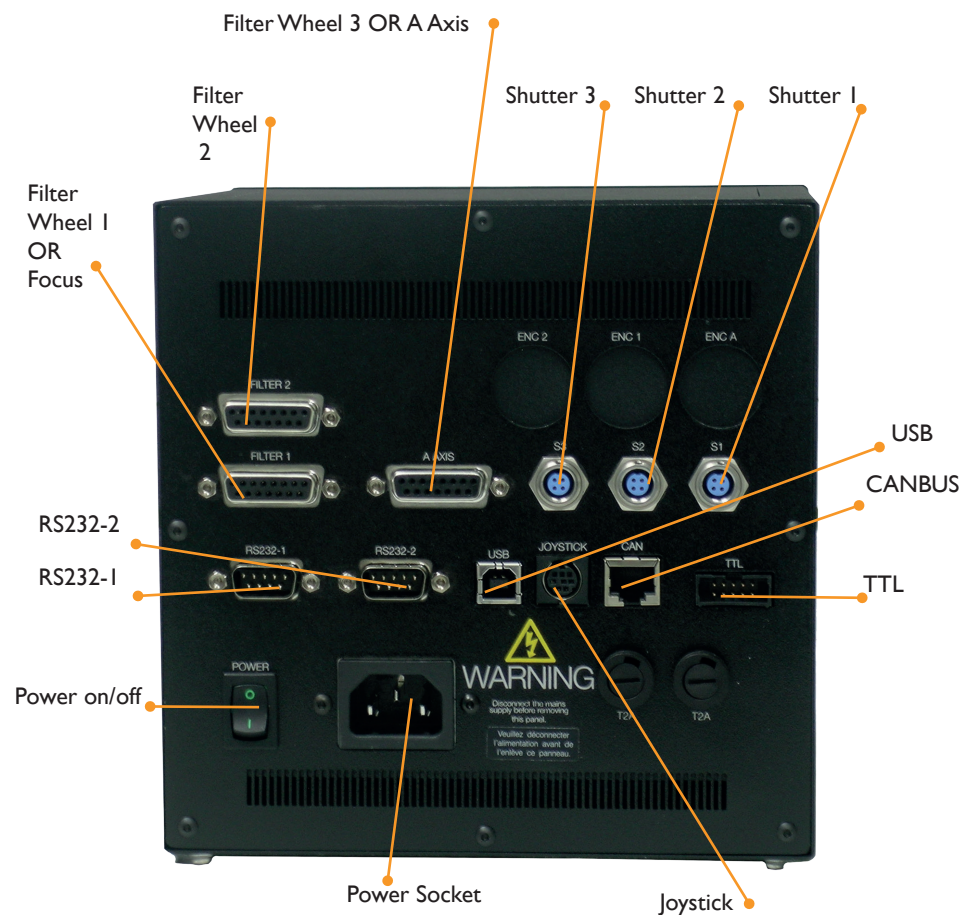

The ProScan III now utilises Win. 7, 8 and 10 compatible driver which automatically install.

**ALWAYS MAKE SURE THE POWER TO THE PROSCAN III IS OFF BEFORE CONNECTING OR DISCONNECTING ANY COMPONENTS**



# PROSCAN III CONNECTIONS

# PROSCAN III CONNECTIONS

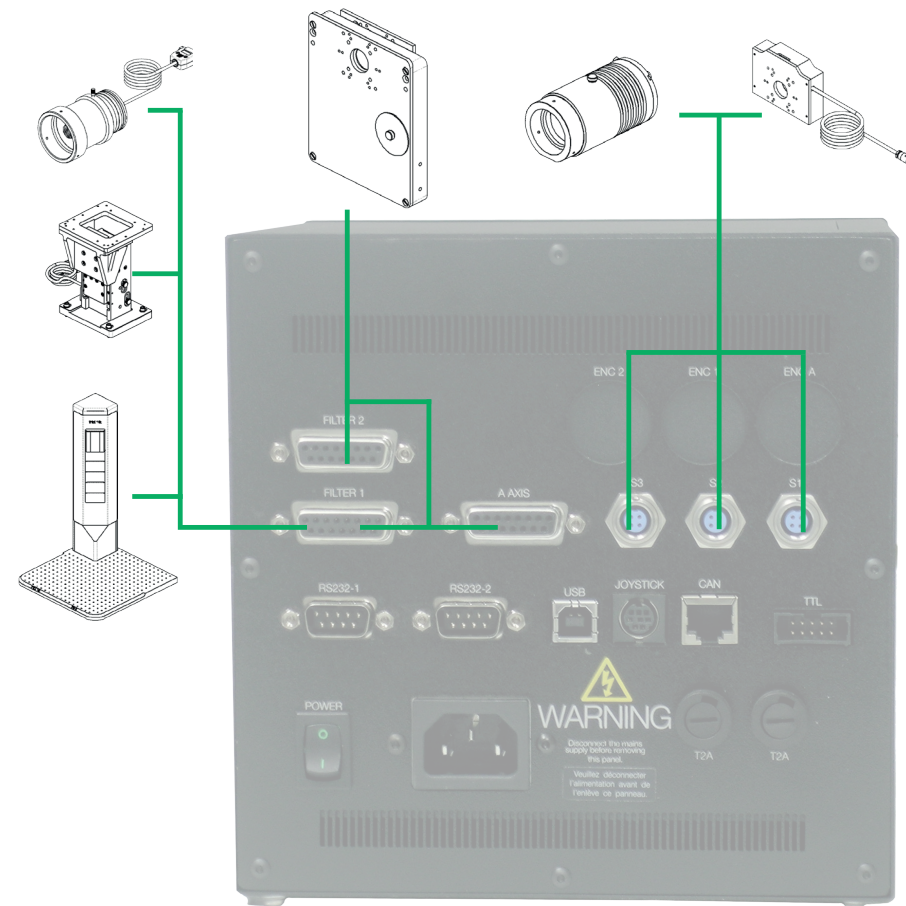
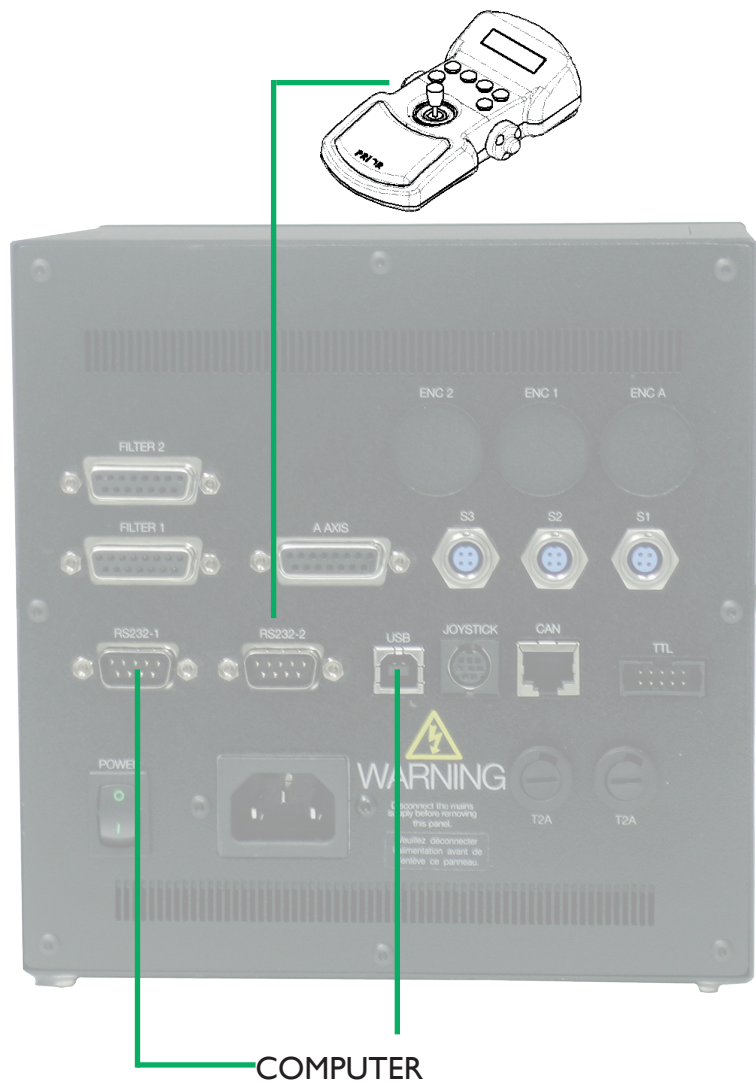

Note that "FILTER 1" supports BOTH filter wheels AND focussing-mechanisms

**ALWAYS MAKE SURE THE POWER TO THE PROSCAN III IS OFF BEFORE CONNECTING OR DISCONNECTING ANY COMPONENTS!**

**READ THE MANUAL BEFORE USE ([WWW.PRIOR.COM](http://WWW.PRIOR.COM))**